

RMCS-1024 Nema17 Stepper Motor

5.6Kgcm Premium Quality

General Specifications	
Motor Type	Stepper Motor
Step Angle	1.8
Rated Voltage	2.8V DC
Holding Torque (Kgcm)	5.5 Kgcm
Detent Torque (Kgcm)	0.2 Kgcm
Rotor Inertia (Gcm ²)	72
Rated Current (A)	1.68
Resistance Per Phase (10%E)	1.65
Inductance Per Phase (20% _{mH})	4.5
Insulation Class	Class B
Insulation Resistance (ME)	100 Min
Number Of Phase	2
Motor Length Without Shaft	48 mm
Weight	380 Grams

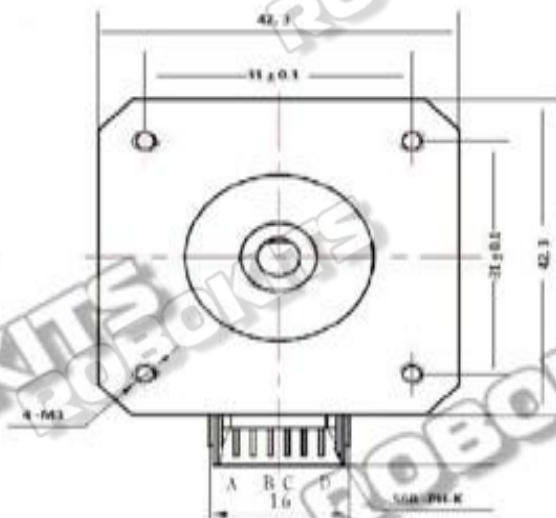
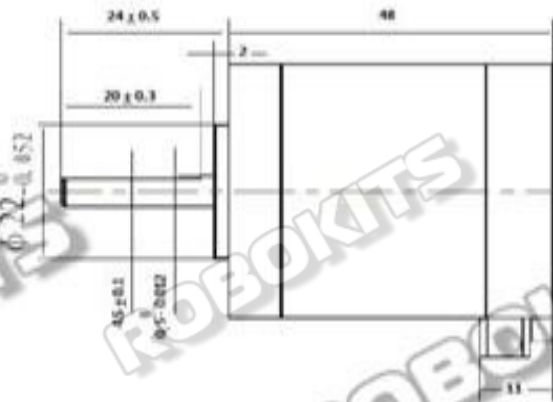
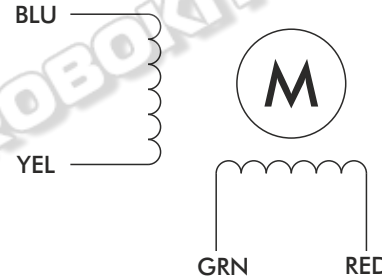

RHINO