

# RMCS-1015 NEMA17 4.2Kgcm Stepper Motor (With D Shaft) - Economy

General Specifications	
Step Angle	1.8 Degree
Temperature Rise (C)	80 Max
Ambient Temperature Rise (C)	-20 To +50
Number Of Phase	2
Insulation Resistance (ME)	100
Insulation Class	Class B
Max. Radial Force (N)	28
Max. Axial Force (N)	10

Electrical Specifications	
Rated Voltage (V)	3.2
Rated Current (A)	1
Resistance Per Phase (10%E)	2.4
Inductance Per Phase (20% $mH$ )	6.5
Holding Torque (Kgcm)	4.2
Detent Torque (G.cm)	200
Rotor Inertia (G.cm <sup>2</sup> )	68
Weight Kg	0.35

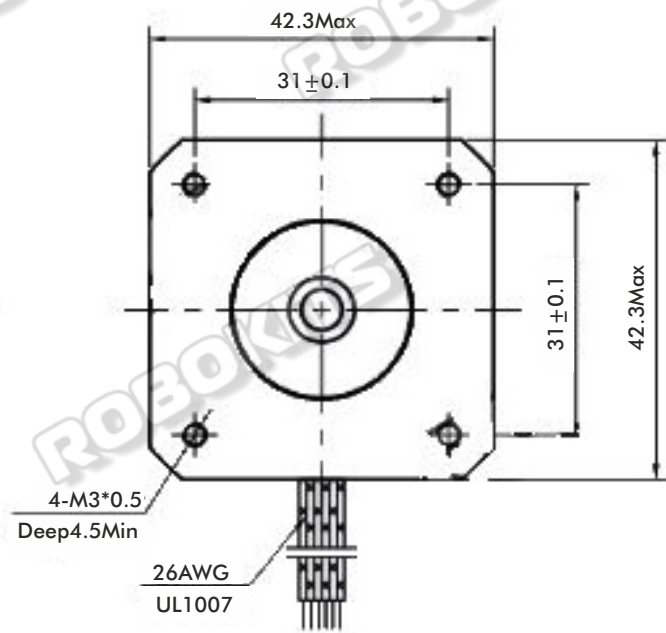
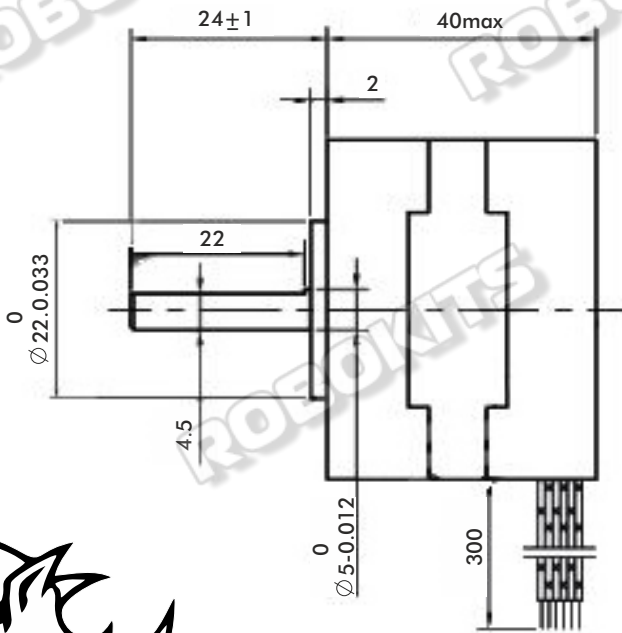
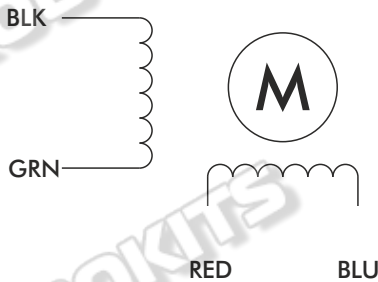

**RHINO**